

# Machine Condition Analyzer A30

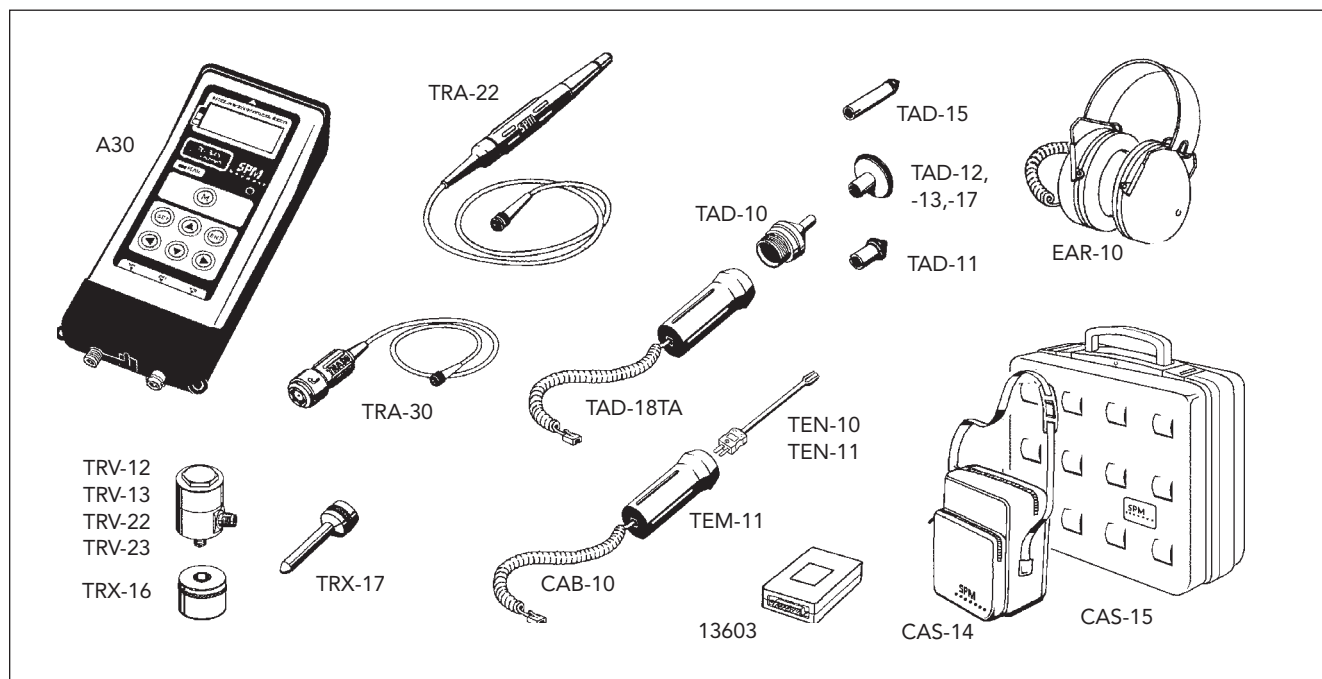

## Part Numbers

A30-1	Machine Condition Analyzer A30 Basic
A30-2	Machine Condition Analyzer A30 Logger
A30-3	Machine Condition Analyzer A30 Expert
13603	Communication module
CAB-31	Computer cable, male 25 pins- female 25 pins
CAB-32	Computer cable, male 25 pins- female 9 pins
CAS-14	Carrying case
CAS-15	Carrying case with foam insert
EMD-13	Carrying strap
FUP-02	Follow-up form for A30, pad of 25 (mm)
FUP-04	Follow-up form for A30, pad of 25 (inch)

### Shock pulse monitoring

TRA-20	Quick conn. transducer for measuring stud
TRA-22	Shock pulse transducer, probe assembly
TRA-30	Shock pulse transd. with quick connector
EAR-10	Earphone in eardefenders, headset, incl. cable
EAR-11	Earphone in eardefenders, for helmet, incl. cable
CAB-07	Cable for remote monitoring, 1.5 m (6 ft)

### Vibration monitoring

TRV-12	Vibration transducer M8 (0-1000 Hz)
TRV-13	Vibration transducer UNF 1/4"-28 (0-1000 Hz)
TRV-22	Vibration transducer M8 (0-5000 Hz)
TRV-23	Vibration transducer UNF 1/4"-28 (0-5000 Hz)
TRX-16	Magnetic foot for vibration transducer
TRX-17	Probe for vibration measurement
VIC-19	Cable for vibration transducer, 1.5 m

### Speed monitoring

TAD-10	Contact adapter for tachometer probe
TAD-11	Contact center, rpm, short
TAD-15	Contact center, rpm, long
TAD-12	Contact wheel, meter/min.
TAD-13	Contact wheel, yards/min.
TAD-17	Contact wheel, feet/min.
TAD-14	Reflecting tape, pad of 5 sheets
TAD-16	Reflecting tape for thin shafts, 5 sheets
TAD-18TA	Tachometer probe with cable

### Temperature monitoring

TEN-10	Temperature probe tip, surface
TEN-11	Temperature probe tip, liquid
TEM-11	Temperature probe with cable

### Spare parts

13108	Sleeve for probe tip (TRA-22)
CAB-02	Cable for TRA-20, 1.5 m (5 ft)
CAB-06	Cable for TRA-22, 1.5 m (5 ft)
CAB-10	Spiral cable for TAD-18, TEM-11
CAB-30	Cable for TRA-30
90022	Battery 1.5 V, alkaline, AA-cell

